

Toggle switches 2 and 3 positions

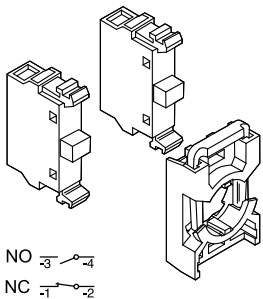
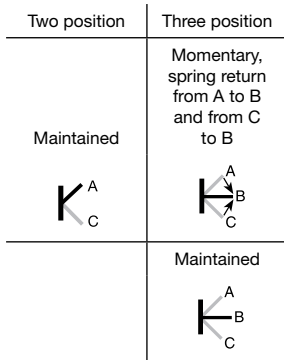
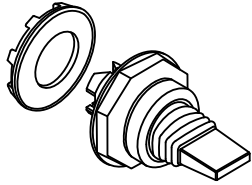

Description	Catalog number	List price
2-position		
Maintained, black bezel	G1MTS1-10B	\$ 26.00
Maintained, chrome bezel	G2MTS1-30B	28.00
3-position		
Maintained, black bezel	G1MTS3-10B	26.00
Maintained, chrome bezel	G2MTS3-30B	28.00
Spring return from A and C to B, black bezel	G1MTS2-10B	26.00
Spring return from A and C to B, chrome bezel	G2MTS2-30B	28.00

Contact blocks and holder

Blocks	Catalog number	Ref. code	List price
1 NO with holder	MCBH-10	1SFA 611 605 R1101	\$ 10.00
1 NC with holder	MCBH-01	1SFA 611 605 R1110	10.00
2 NO with holder	MCBH-20	1SFA 611 605 R1102	18.00
2 NC with holder	MCBH-02	1SFA 611 605 R1120	18.00
1 NO + 1 NC with holder	MCBH-11	1SFA 611 605 R1111	18.00
1 NO without holder	MCB-10	1SFA 611 610 R1001	8.00
1 NC without holder	MCB-01	1SFA 611 610 R1010	8.00
Holder for 3 blocks	MCBH-00	1SFA 611 605 R1100	2.00

Contact block functions

Block positions as seen from operator front.

2-position maintained switch

Handle position	Left block	Right block
A	O	O
C	x	x

O = not actuated (normal state)
x = actuated (state changed)

3-position switch

Handle position	Left block	Middle block	Right block
A	O	x	x
B	O	O	O
C	x	x	O

O = not actuated (normal state)
x = actuated (state changed)

Center position connection detail

