

Pilot lights

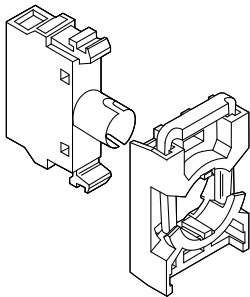

Lamp block + holder

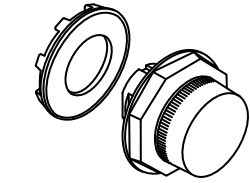

Diffusing lens

Δ Lens color	R Red
	G Green
	Y Yellow
	L Blue
	W White
	C Clear

Description	Catalog number	List price
Black plastic mounting ring	G1ML1-100Δ	\$ 12.50
Chrome mounting ring	G2ML1-100Δ	14.50

Lamp blocks with holder [Ⓞ]

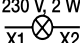
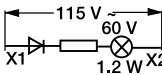
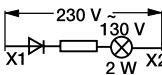
Supply voltage	Catalog number	Ref. code	List price
For max. 2 W, 230 V AC and DC filament bulb or LED 230 V, 2 W 	MCBH-001	1SFA 611 605 R1200	\$ 19.50
115 V AC supply voltage. For 60 V filament bulb max. 1.2 W 	MCBH-002	1SFA 611 605 R1300	23.50
230 V AC supply voltage. For 130 V filament bulb max. 2 W 	MCBH-003	1SFA 611 605 R1400	23.50

Light diffusing lens

To improve illumination. *Note: Cannot be used with text cap.*

Description	Catalog number	Ref. code	List price
The lens is used instead of text cap	KA1-8005	1SFA 616 920 R8005	\$ 3.00

[Ⓞ] Bulb not included. See page 18