

Accessories

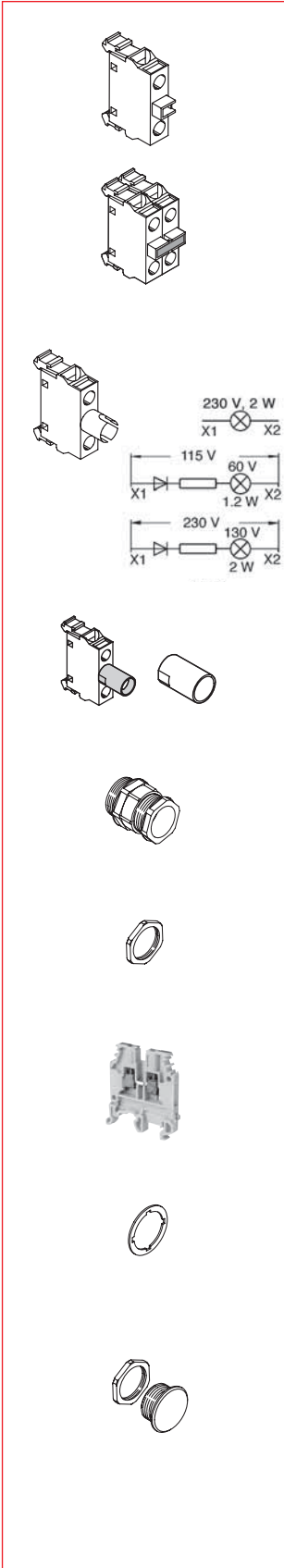

Contact blocks for rear mounting

Description	Catalog No.	Ref. Code	List Price
Contact block			
1NO	MCB-10B	1SFA 611 610 R2001	\$ 8.00
1NC	MCB-01B	1SFA 611 610 R2010	
Double contact block			
2NO	MCB-20B	1SFA 611 610 R2002	16.00
2NC	MCB-02B	1SFA 611 610 R2020	
1NO+1NC	MCB-11B	1SFA 611 610 R2011	
Contact block with gold plated contacts			
1NO	MCB-10BG	1SFA 611 610 R2101	16.00
1NC	MCB-01BG	1SFA 611 610 R2110	
Lamp blocks			
For max. 2 W, 230 V AC and DC filament bulb or LED	MLB-1B	1SFA 611 620 R2001	17.50
115 V AC supply voltage. For 60 V filament bulb max. 1.2 W	MLB-2B	1SFA 611 620 R2002	21.50
230 V AC supply voltage. For 130 V filament bulb max. 2 W	MLB-3B	1SFA 611 620 R2003	21.50

Protective sleeve

Description	Catalog No.	Ref. Code	List Price
To make a rear mounted lamp block screen protected. IP20	5396 0543-1	5396 0543-1	\$ 2.00

Earthing terminal

Description	Catalog No.	Ref. Code	List Price
For plastic enclosure.	MA5-2005	1SFA 611 925 R3005	\$ 2.00

Spacer

Description	Catalog No.	Ref. Code	List Price
1 mm thick. Needed when legend plates are not used in plastic enclosures. Spacer (Packing unit 10 pieces)	SK 615 516-1	SK 615 516-1	\$ 1.00
Spacer for Modular emergency stop pushbutton, page ?? (Packing unit 10 pieces)	KA1-8045	1SFA 616 920 R 8045	1.00

Blanking plug (22mm)

Description	Catalog No.	Ref. Code	List Price
Black plastic	SK 615 502-B	SK 615 502-B	\$ 2.00